



MODEL "SL"

RUMP BONE & CARCASS SPLITTER

PARTS & SERVICE MANUAL

Warning

ALWAYS EXERCISE CARE WHEN OPERATING OR PERFORMING MAINTENANCE, REPAIRS AND ADJUSTMENTS. ALWAYS DISCONNECT ELECTRICAL CONNECTOR BEFORE ATTEMPTING TO WORK ON THIS TOOL. BE SURE ALL ELECTRICAL MACHINES ARE PROPERLY GROUNDED. NEVER ALLOW ANY PART OF YOUR PERSON OR ANY OTHER PERSON IN THE PATH OF THE BLADE WHILE THE TOOL IS IN SERVICE.

USDA
APPROVED

CE

Best & Donovan

5570 CREEK ROAD, CINCINNATI, OHIO 45242, USA

TOLL FREE: 1-800-553-2378

TELEPHONE: (513) 791-9180

FAX: 513-791-0925

WEBSITE: www.bestanddonovan.com

E-MAIL: info@bestanddonovan.com

WARRANTY

Best & Donovan warrants the machine against defective parts & workmanship for (30) days from date of factory shipment. In the fulfillment of its warranty, the sole obligation of Seller shall be to repair or replace, at its option F.O.B. its factory, shipping charges prepaid, and which after inspection by Seller are found to be defective. Buyer shall notify Seller of defect in writing, promptly upon discovery, within the warranty period. This warranty does not cover defects caused by corrosion or normal deterioration. It does not extend to consequential damage, loss or delay associated with a warranty defect and it does not cover any costs of labor, travel or other expenses associated with the repair or replacement of defective parts. Seller assumes no liability for product loss or other claims whatsoever arising out of the use of application of the machine in Meat Slaughtering/Processing operations, whether the machine is used alone or in conjoint use with other Meat Slaughtering/Processing Machines or Processes. This warranty is voided if repairs, replacements or alterations are made by others without prior authorization by Seller. Notwithstanding the foregoing, Seller's warranty obligations with respect to any items not manufactured by Seller shall not exceed the obligations undertaken by the manufacturer thereof under express warranty to the Seller. This express warranty is in lieu of all other warranties of fitness of the machine for any particular purpose.

SERVICE INFORMATION AND PREVENTATIVE MAINTENANCE SCHEDULE FOR BEST & DONOVAN

BEST & DONOVAN REALIZES THAT THERE MAY BE MANY DIFFERENT APPROACHES TO PROPER MAINTENANCE, ASSEMBLY DISASSEMBLY, AND ADJUSTMENT PROCEDURES. THE FOLLOWING PROCEDURES SHOULD BE USED AS A GUIDELINE AND WHETHER ACCEPTED OR USED IN THEIR ENTIRETY OR PARTIALLY, IS NOT A SUBSTITUTE FOR PROPER MECHANICAL ABILITY AND/OR KNOWLEDGE.

ONLY PERSONNEL WITH PROPER MECHANICAL AND TECHNICAL SKILLS SHOULD ATTEMPT ANY SERVICE PROCEDURES.

.....

THE FOLLOWING SERVICE INFORMATION WILL DESCRIBE IMPORTANT NOTATIONS REQUIRING SPECIAL ATTENTION BY THE TECHNISIAN(S) PERFORMING SERVICE TASKS. THEY ARE: **WARNING**, **CAUTION**, and **NOTE**.

- WARNING:** WILL DESCRIBE CONDITIONS THAT EXIST OR POTENTIALLY EXIST THAT CAN CAUSE INJURY OR DEATH.
- CAUTION:** WILL DESCRIBE CONDITIONS THAT EXIST OR POTENTIAL EXIST THAT CAN CAUSE INJURY OR EQUIPMENT FAILURE.
- NOTE:** WILL DESCRIBE A SPECIFIC HELPFUL PROCEDURE.

RECEIVING & INSPECTION

INSPECT YOUR BEST & DONOVAN MODEL "SL" SAW FOR POSSIBLE DAMAGE AS SOON AS YOU RECEIVE IT. IF YOU DISCOVER ANY DAMAGE, NOTIFY CARRIER'S AGENT AT ONCE AND REQUEST HIM TO INSPECT THE DAMAGE, ALSO NOTIFY BEST & DONOVAN. CHECK PACKING LIST AGAINST THE CONTENTS.

MODEL "SL" RUMP BONE SAW SPECIFICATIONS

WEIGHT OF THE MODEL "SL" SAW WITH BLADE	137 LBS. (65 KILOS.)
LENGTH OF MODEL "SL" SAW INCLUDING BLADE	48 INCHES (1219.2 mm.)
COUNTERBALANCER	6343300
WEIGHT RANGE	132-165 (62.8-78.5 KILOS.)
CABLE TRAVEL	6.56 FEET (2 METERS)
SAW BLADES	TYPE A – 4 TEETH/INCH 6100900
	TYPE SS – 2 TEETH/INCH 6101200
	TYPE H – 3 TEETH/INCH 6101100
	TYPE AR – 2 TEETH/INCH 6101000
ELECTRICAL SPECIFICATIONS	2 H.P. (1.49 kw) 3 PHASE 60 HZ.

ELECTRICAL REQUIREMENT: SEE ELECTRICAL INSTALLATION DIAGRAM & SPECIFICATIONS ON TOOL IDENTIFICATION TAG FOR VOLTAGE AMPS & CYCLE.

INSTALLATION & MAINTENANCE INSTRUCTIONS

WARNING

ALWAYS EXERCISE CARE WHEN OPERATING OR PERFORMING MAINTENANCE, REPAIRS AND ADJUSTMENTS. ALWAYS DISCONNECT ELECTRICAL CONNECTOR BEFORE ATTEMPTING TO WORK ON THIS TOOL. BE SURE ALL ELECTRICAL MACHINES ARE PROPERLY GROUNDED. NEVER ALLOW ANY PART OF YOUR PERSON OR ANY OTHER PERSON IN THE PATH OF THE BLADE WHILE THE TOOL IS IN SERVICE.

INSTALLTION

HANGING THE MODEL "SL"

THE MODEL "SL" WEIGHS 137 POUNDS (65 KILOS). IT IS RECOMMENDED TO USE BEST & DONOVAN COUNTERBALANCE #6343300 WITH A 6.56 FOOT (2 METERS) CABLE TRAVEL.

ADJUST THE BALANCER SO THAT THE TOOL HANGS SUSPENDED ABOUT WAIST HIGH, WITHOUT DROPPING TO THE FLOOR OR RISING BY ITSELF. THE OPERATOR SHOULD BE ABLE TO RAISE THE MODEL "SL" TO ITS STARTING POSITION WITH A MINIMAL AMOUNT OF EFFORT.

THIS DIAGRAM SHOULD GIVE THE INSTALLTION OF THE MODEL "SL" A GOOD POSITIONING FOR THE CUTTING OF THE CARCASS. MINOR ADJUSTMENTS IN THE MEASUREMENTS MAY BE NEEDED TO FIT THE INSTALLATION AREA.

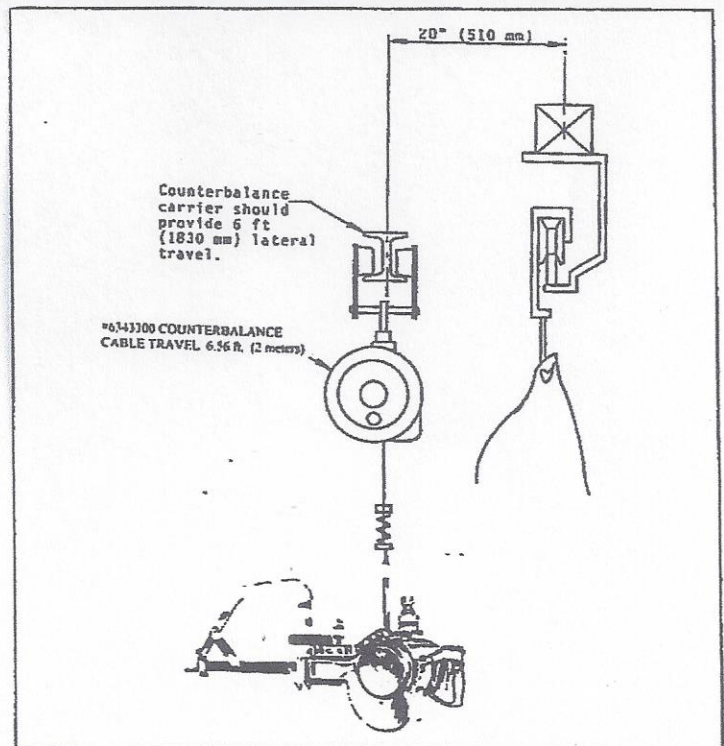

ELECTRICAL INSTALLTION

WARNING

ALWAYS EXERCISE CARE WHEN OPERATING OR PERFORMING MAINTENANCE, REPAIRS, AND ADJUSTMENTS. ALWAYS DISCONNECT ELECTRICAL CONNECTOR BEFORE ATTEMPTING TO WORK ON THIS TOOL. BE SURE ALL ELECTRICAL MACHINES ARE PROPERLY GROUNDED. NEVER ALLOW ANY PART OF YOUR PERSON OR ANY OTHER PERSON IN THE PATH OF THE BLADE WHILE THE TOOL IS IN SERVICE.

NOTE: PLEASE READ THE MOTOR ROTATION SECTION BELOW THE ELECTRICAL DIAGRAM BEFORE STATING THE MODEL "SL".

CHECK THE ELECTRICAL INSTALLATION DIAGRAMS BELOW FOR THE CORRECT CONTROL CIRCUIT TO YOUR TOOL. THE CONTROL CIRCUIT FOR THE STARTER MUST BE 50 VOLTS OR LESS. HIGHER THAN 50 VOLTS WILL DAMAGE THE HANDLE TRIGGER SWITCHES. WE RECOMMEND A STEP-DOWN TRANSFORMER TO 24 VAC FOR THE HOLDING COIL SIDE OF THE CIRCUIT. THE TRIGGERS, WHEN DEPRESSED, ARE CONNECTED TO A 24 VAC HOLDING RELAY WHICH PULLS IN THE STARTER COIL TO ENGAGE THE MOTOR STARTER TO THE SAW.

**ELECTRICAL CONNECTION DIAGRAM
3-PHASE 24/42 VOLT
24/42 VOLT DUAL SIMULTANEOUS CONTROL**

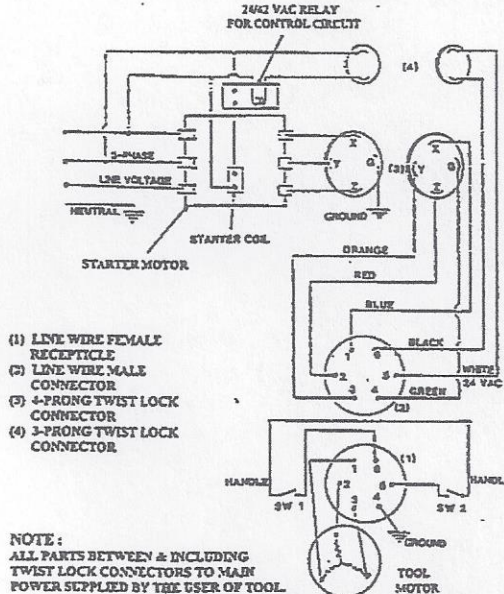

NOTE:
ALL PARTS BETWEEN & INCLUDING
TWIST LOCK CONNECTORS TO MAIN
POWER SUPPLIED BY THE USER OF TOOL

IMPORTANT NOTE FOR OPTIONAL WATER SPRAY VALVE INSTALLATION
WHEN CONNECTING THE WATER SOLENOID VALVE TO ANY EXISTING SYSTEM OR NEW
INSTALLATION, MAKE SURE THAT THE STEP-DOWN TRANSFORMER HAS THE CAPACITY
TO HANDLE BOTH THE STARTER COIL AND COIL TO THE WATER VALVE. CHECK THE
RMSH CURRENT FOR THE CIRCUIT.

**ELECTRICAL CONNECTION DIAGRAM
3-PHASE 110 THRU 575 VOLT
24 VOLT DEAD SIMULTANEOUS CONTROL**

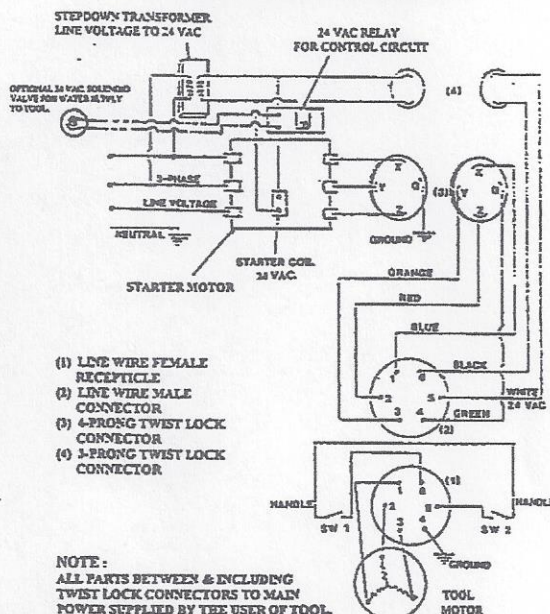

NOTE:
ALL PARTS BETWEEN & INCLUDING
TWIST LOCK CONNECTORS TO MAIN
POWER SUPPLIED BY THE USER OF TOOL.

MOTOR ROTATION

CORRECT ROTATION OF THE MOTOR IS EXTREMELY IMPORTANT, AS ALL PARTS ON THE "SL" HAVE RIGHT HAND THREADS. SHOULD THE MACHINE RUN IN THE WRONG DIRECTION, THESE PARTS WILL UNSCREW AND CAUSE DAMAGE TO THE MACHINE. THE FRONT COVER SHOULD HAVE A COUNTER-CLOCKWISE ARROW STAMPED ON IT AND THE MACHINE SHOULD ROTATE IN THIS DIRECTION WHEN VIEWED FROM THE COVER SIDE (A) OF THE MACHINE. ROTATE THE GREASE HOLE COVER (B) UP SO THAT YOU CAN VIEW THE INSIDE OF THE MACHINE AND LIGHTLY TAP THE DUAL CONTROL TRIGGERS TO DETERMINE THE ROTATION. SHOULD THE MOTOR RUN IN THE WRONG DIRECTION, SWITCH TWO (2) OF THE BLACK WIRES IN THE FOUR (4) PRONG PLUG AND TRY AGAIN.

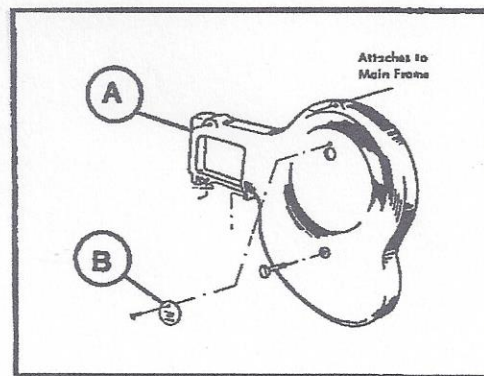

MAINTENANCE INSTRUCTIONS

WARNING

ALWAYS EXERCISE CARE WHEN OPERATING OR PERFORMING MAINTENANCE, REPAIRS, AND ADJUSTMENTS. ALWAYS DISCONNECT ELECTRICAL OR AIR CONNECTOR BEFORE ATTEMPTING TO WORK ON THE MACHINES. BE SURE ALL ELECTRICAL MACHINES ARE PROPERLY GROUNDED. NEVER ALLOW ANY PART OF YOUR PERSON OR ANY OTHER PERSON TO BE IN THE PATH OF THE BLADE WHEN MACHINE IS IN SERVICE. ONLY GRIP MACHINE BY THE HANDLES PROVIDED.

PREVENTATIVE MAINTENANCE IS THE FIRST STEP OF GOOD TOOL MAINTENANCE. A PERIODIC CHECK SHOULD BE MADE TO REPLACE WORN PARTS AND TO INSPECT LUBRICATION LEVELS & EFFECTIVENESS. A WORN PART REPLACED IN TIME MAY SAVE REPAIRS LATER.

THIS IS A PRECISION MACHINE MADE UP OF PRECISION PARTS AND SHOULD BE HANDLED WITH EXTREME CARE. DO NOT SQUEEZE MACHINE OR PARTS IN A HOLDING DEVICE OR OTHERWISE MISUSE. TOO MUCH PRESSURE EXERTED IN A HOLDING DEVICE MAY CAUSE DISTORTION TO THE PART. BE SURE THAT YOU HAVE THE CORRECT TOOLS AND FIXTURES BEFORE ASSEMBLING (OR DISASSEMBLING) THIS TOOL. WHEN ASSEMBLING (OR DISASSEMBLY) BEARINGS, THE PRESSURE SHOULD BE APPLIED TO THE FACE OF THE INNER OR OUTER RACE, WHICHEVER IS ADJACEENT TO THE MATING PART. IF THIS IS NOT DONE, IT WILL DAMAGE THE BEARING RACES MAKING IT NECESSARY TO REPLACE THEM.

OPEN BEARINGS MAY BE WASHED IN ONLY FRECH, CLEANSOLVENT. BEARINGS SHOULD BE WASHED IN A CONTAINER WITH A SCREENED FALSE BOTTOM TO PREVENT FOREIGN PARTICLES FROM BEING STIRRED UP AND CONTAMINATING THE PART. AFTER CLEANING, BLOW SOLVENT OUT OF THE BEARING WITH DRY, CLEAN AIR & RE-PACK WITH GOOD GRADE BEARING GREASE. DO NOT SPIN BEARING, OR ALLOW IT TO SPIN WHEN BLOWING OFF SOLVENT. DO NOT ATTEMPT TO WASH A SEALED OR SHIELDED BEARING.

BEFORE DISASSEMBLING A TOOL, THE AREA AROUND THE WORK BENCH SHOULD BE CLEAN & FREE FROM METAL CHIPS AND OTHER FOREIGN MATTER. IT IS GOOD PRACTICE TO SPREAD A CLEAN CLOTH ON THE WORK BENCH TO PREVENT THE LOSS OF SMALL PARTS.

IT IS IMPORTANT THAT ALL PARTS ARE THOROUGHLY CLEANED & INSPECTED BEFORE ASSEMBLING. THE SLIGHTEST PARTICLES OF DIRT CAN CREATE EXCESSIVE RUN-OUT IN SPINDLE OR OUT OF SQUARENESS IN THE BEARING MOUNTING, CAUSING VIBRATIONS AND LOSS OF SPEED, ULTIMATELY DAMAGING THE MACHINE.

BEFORE REASSEMBLING, ALL PARTS SHOULD BE WASHED AND INSPECTED, REPLACING ANYH WORN OR DEFECTIVE PARTS, APPLYING A SMALL AMOUNT OF GREASE TO STEEL BALLS, SPRINGS AND OTHER SMALL PARTS WILL OFTEN HOLD THEM IN PLACE WHILE REASSEMBLING LUBRICANT IS RECOMMENDED FOR THE INSTALLATION OF "O" RINGS.

WHEN REPARIS ARE NECESSARY, CONSULT DRAWING CONTAINING THE PART FOR IDENTIFICATION. WHEN ORDERING REPAIR OR SPARE PARTS, BE SURE TO LIST MODEL NUMBER, PART NUMBER & PART NAME TO ASSURE PROMPT AND ACCURATE SHIPMENT OF YOUR ORDER.

CLEANING

IT IS ALWAYS BETTER TO CLEAN THE TOOL WITH STEAM THAN WITH HIGH PRESSURE HOT WATER. THE COMPLETE EXTERIOR MAY BE SPRAYED CLEAN WITH THE EXCEPTION OF INSIDE THE ELECTRICAL PLUG BASE, INSIDE THE REAR HEAD, AND AROUND THE SIDE & REAR HANDLES SWITCH PLATES. THE FRONT COVER SHOULD BE REMOVED ONCE A WEEK FOR CLEANING OF THE DRIVING PARTS.

LUBRICATION

OIL FROM THE SIGHT FEED DRIP OILER WILL LUBRICATE THE GUIDES, THE CROSSHEAD, AND THE BUSHING. FILL THE OILER WITH USDA APPROVED MINERAL OIL AND ADJUST THE STEM TO DRIP 7 TO 10 DROPS PER MINUTE. THE CONNECTING ROD BEARING SHOULD BE GREASED ONCE A DAY. TO ACCOMPLISH THIS, ROTATE THE GREASE HOLE COVER OPEN. ROTATE THE MACHINE UNTIL THE GREASE FITTING IS EXPOSED AND GREASED. THE MOTOR SHOULD BE GREASED WHENEVER THE FRONT COVER IS REMOVED FOR CLEANING OR AT LEAST ONCE A WEEK. THE CRANK HAS TWO ACCESS HOLES WHICH WILL ALLOW YOU TO GREASE THE GREASE FITTINGS. ROTATE THE CRANK AS NECSSARY. THE REAR MOTOR BEARING SHOULD BE GREASED AT THIS TIME.

ADJUSTMENTS

THE GUIDES SHOULD BE ADJUSTED WHENEVER THE CROSSHEAD HAS EXCESSIVE SHAKE. THIS SHOULD BE CHECKED ABOUT ONCE PER WEEK. TO MAKE THIS ADJUSTMENT, LOOSEN THE FOUR (4) LOWER GUIDE PLATE SCRES $\frac{1}{2}$ TURN AFTER LOOSENING THE FOUR (4) NUTS. THIS LOWER GUIDE PLATE CAN NOW BE ADJUSTED WITH THE SET SCREWS. THESE SET SCREWS SHOULD BE MOVED VER LITTLE AT A TIME UNTIL ALL THE SET SCREWS HAVE BEEN SET TITH THE SHAKE TAKEN OUT OF THE CROSSHEAD. RETIGHTEN THE GUIDE PLATE SCREWS AND NUTS, PROVE YOUR ADJUSTMENTS BY RUNNING THE SAW FOR A MINUTE.

CAUTION: INSPECT THE SAW GUIDES TO INSURE THAT THE BLADE SLIDES FREELY. INSPECT SAW BLADES FOR FATIGUE CRACKS BEFORE USING.

WHEN SAW BLADES ARE RESHARPENED, FILE A 20 DEGREE BEVEL FRONT AND BACK ALTERNATELY PER TOOTH. TOOTH GULETS MUCH BE ROUNDED. DO NOT SET THE TEETH.

CAUTION: SAW BLADES SHOULD BE KEPT SHARP AT ALL TIMES. TO NEGLECT THIS WILL CAUSE POOR CUTTING, POSSIBLE OVERLOAD OF THE MOTOR AND THE MACHINE WILL BE SUGJECT TO SEVERE STAIN AND PREMATURE WEAR WILL OCCUR.

DISASSEMBLY & REASSEMBLY OF THE SAW

SAW YOKE

WHEN REASSIMBLING THE SAW YOKE, ALWAYS INSURE THAT THE SAW BLADE SLIDES FREELY AND STRAIGHT. IT MAY BE NECESSARY TO SHIM THE EXTENSION SAW GUIDE #6 IN OR OUT WITH THE PROPER AMOUNT OF SHIMS #7. THEN REAR SAW GUIDE #19 CAN BE PROPERLY POSITIONED WITH SHIMS #19. THE COMPLETE YOKE SHOULD BE PROPERLY POSITIONED WITH SHIMS #13 SO THAT THE BLADE JUST SITS FLAT ON THE CROSSHEAD FACE.

DRIVING PARTS

REMOVE THE FRONT COVER #113. REMOVE THE THE CONNECTING ROD #27 TO CROSSHEAD BOLT #24. REMOVE THE BEARING CAP #83 AND BOLT #84. LIFT THE CONNECTING ROD #27 STRAIGHT UP AND OFF. PLACE A BAR IN THE MAIN FRAME TO STOP THE CRANK #88 FROM TURNING. UNSCREW THE ROTOR LOCK NUT #87. RIGHT HAND THREADS. REMOVE THE BAR WHICH LOCKED THE CRANK FROM TURNING. USING A BRASS BAR, TAP AGAINST THE WEIGHT END OF THE CRANK TO UNSCREW IT FROM THE ROTOR, RIGHT HAND THREADS. IF THIS DOES NOT WORK, THE STATOR WILL HAVE TO BE REMOVED AND THE ROTOR WILL HAVE TO BE HELD IN A SOFT JAWED VISE. AFTER THE CRANK #88 IS REMOVED, REMOVE THE SPACER #89 AND THE BEARING LOCK NUT #90 RIGHT HAND THREADS. IF THE CONNECTOR ROD BEARING #86 BEARING #86 IS TO BE REPLACED, REMOVE THE OUTER SEAL OF THE NEW BEARING TO ALLOW GREASE IN.

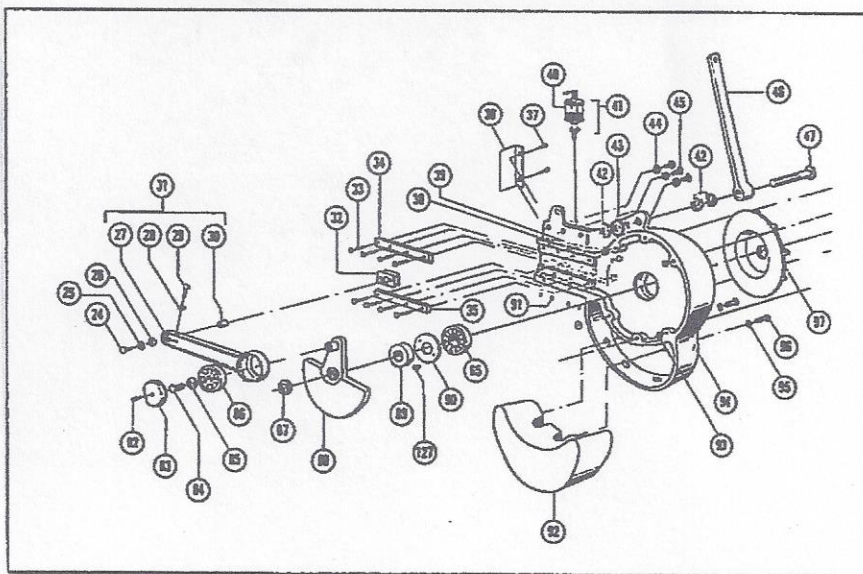
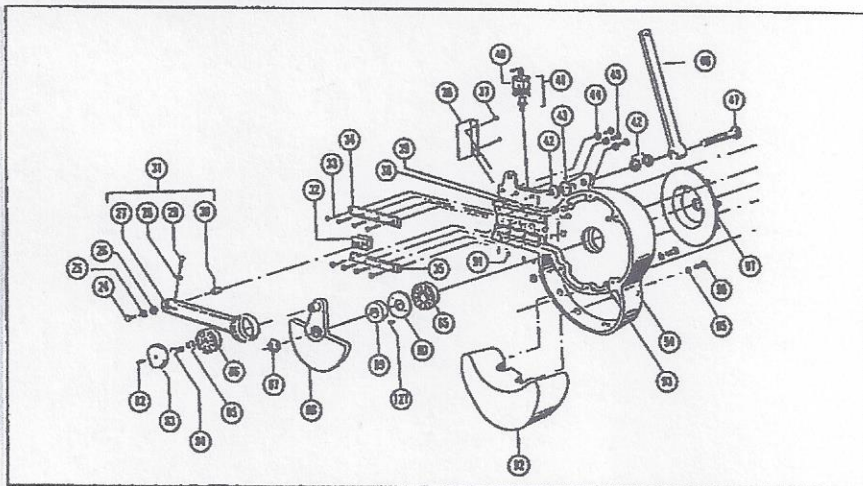

DISASSEMBLY & REASSEMBLY OF THE SAW (CONTINUED)

ELECTRIC MOTOR

REMOVE THE FOUR (4) MOTOR BOLTS #102 BY REMOVING THE NUTS #67 OR #93. REMOVE THE REAR BEARING COVER #66 AND REAR ROTOR LOCK NUT #87, RIGHT HAND THREADS. LOOSEN THE FOUR (4) MOTOR CASE SET SCREWS #100. USING WOODEN BLOCKS, TAP THE REAR HEAD #64, MOTOR CASE & STATOR #98 OFF THE MAIN FRAME. SUPPORT THE MAIN FRAME AND TAP THE ROTOR OUT. USE A WOODEN BLOCK AGAINST THE END OF THE CRANK SO NOT TO DAMAGE THE THREADS. THE FAN HAS RIGHT HAND THREADS. WHEN REASSEMBLING, MAKE SURE THE MOUNTING SURFACES ARE SMOOTH AND TIGHT TO INSURE THAT THE ROTOR DOES NOT BIND REVERSE THIS PROCEDURE TO ASSEMBLE.

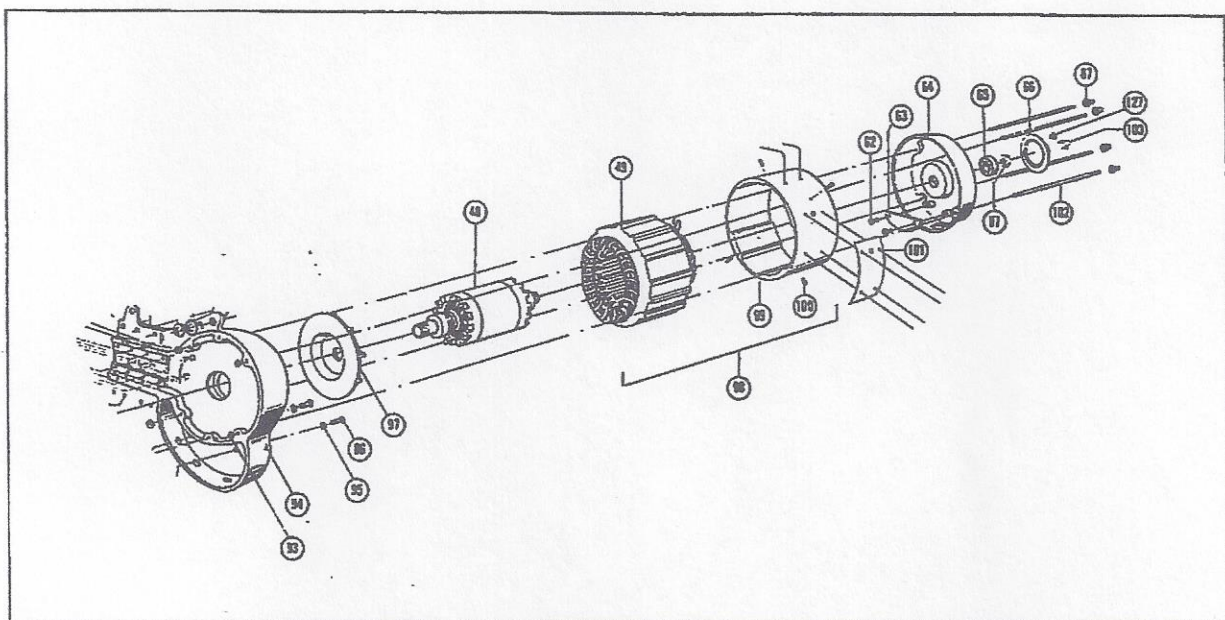

WARNING

ALWAYS EXERCISE CARE WHEN OPERATING OR PERFORMING MAINTENANCE, REPAIRS AND ADJUSTMENTS. ALWAYS DISCONNECT ELECTRICAL CONNECTOR BEFORE ATTEMPTING TO WORK ON THIS TOOL. BE SURE ALL ELECTRICAL MACHINES ARE PROPERLY GROUNDED. NEVER ALLOW ANY PART OF YOUR PERSON OR ANY OTHER PERSON IN THE PATH OF THE BLADE WHILE THE TOOL IS IN SERVICE.

YOKE SECTION

<u>REF. NO.</u>	<u>PART NO.</u>	<u>DESCRIPTION</u>	<u>QTY.</u>
1	8519950	SAW YOKE COMPLETE - STEEL	1
2	9901524	HEX HEAD SCREW	1
3	8505800	FRONT SAW GUIDE	1
4	8507200	SCABBARD	1
5	9901489	HEX HEAD SCREW	5
6	8504800	EXTENSION SAW GUIDE	1
7	8505000	1/16" SHIM	A/R
	8504900	.005 SHIM	A/R
	8505100	.010 SHIM	A/R
8	9902308	STOP NUT	7
9	9902310	STOP NUT	4
10	6098198	SIDE HANDLE (SEE SIDE HANDLE REF. PAGE)	1
11	8504060	SAW YOKE - ALUMINUM	1
	8519960	SAW YOKE - STEEL	1
12	9901542	HEX HEAD SCREW	1
13	8515600	.005 SHIM	A/R
	8515700	.010 SHIM	A/R
	8515800	.020 SHIM	A/R
14	8505500	FRONT WEAR PLATE	1
15	9901502	HEX HEAD SCREW	1
16	8504500	TAILHOLDER - LEFT	1
17	8506600	REAR SAW GUIDE	1
18	8506500	REAR WEAR GUIDE	1
19	8521800	.005 SHIM	A/R
	8522100	.010 SHIM	A/R
20	8504600	TAILHOLDER - RIGHT	1
21	8513793	HEX HEAD SCREW	1
22	9901937	LOCK WASHER	1
23	8513800	WASHER	1

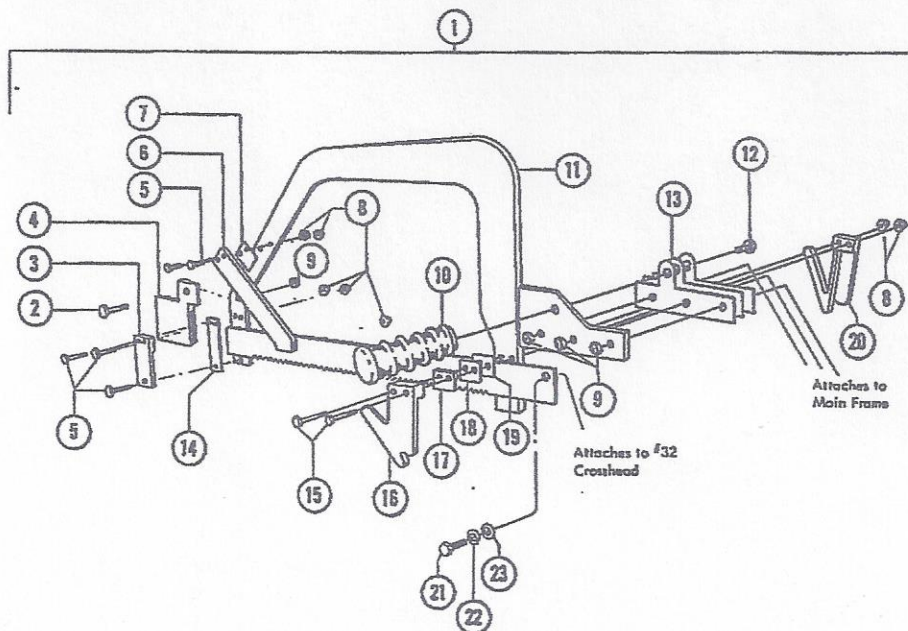

DRIVE SECTION

REF. NO.	PART NO.	DESCRIPTION	QTY.
24	9901490	HEX HEAD SCREW	1
25	9901975	LOCK WASHER	1
26	8513600	WASHER	1
27	8512400	CONNECTING ROD	1
28	OBSOLETE	WASHER	
29	9801163	SCREW	1
30	8512900	BUSHING	1
31	8512450	CONNECTING ROD ASSY.	1
32	8510700	CROSSHEAD	1
33	9901164	SCREW	8
34	8518400	GUIDE PLATE - TOP	1
35	8518500	GUIDE PLAT - ADJUSTABLE	1
36	8506200	BONE DUST SHIELD	1
37	9902700	HEX HEAD SCREW	1
38	9901975	LOCK WASHER	8
39	9901706	HEX NUT	8
40	8510293	GLASS ONLY	1
41	8503993	SIGHT FEED DRIP OILER	1
42	9901722	HEX NUT	3
43	9901963	LOCK WASHER	1
44	9901937	LOCK WASHER	3

REF. NO.	PART NO.	DESCRIPTION	QTY.
45	9901524	HEX HEAD SCREWS	3
46	8502800	SUSPENSION ARM	1
47	8503000	BOLT	1
82	8512793	GREASE FITTING	1
83	8512500	BEARING CAP	1
84	7025600	BOLT	1
85	8511400	WASHER	1
86	8512893	BEARING	1
87	8507900	ROTOR LOCK NUT	1
88	8511100	CRANK	1
89	8511300	SPACER	1
90	8503100	BEARING LOCK NUT	1
91	9901882	SET SCREW	1
92	8521700	INERTIA WEIGHT	1
93	9901679	NUT	4
94	8500100	MAIN FRAME	1
95	9901937	LOCK WASHER	1
96	9901524	HEX HEAD SCREW	1
97	8511698	FAN	1
127	6031201	GREASE FITTING	1

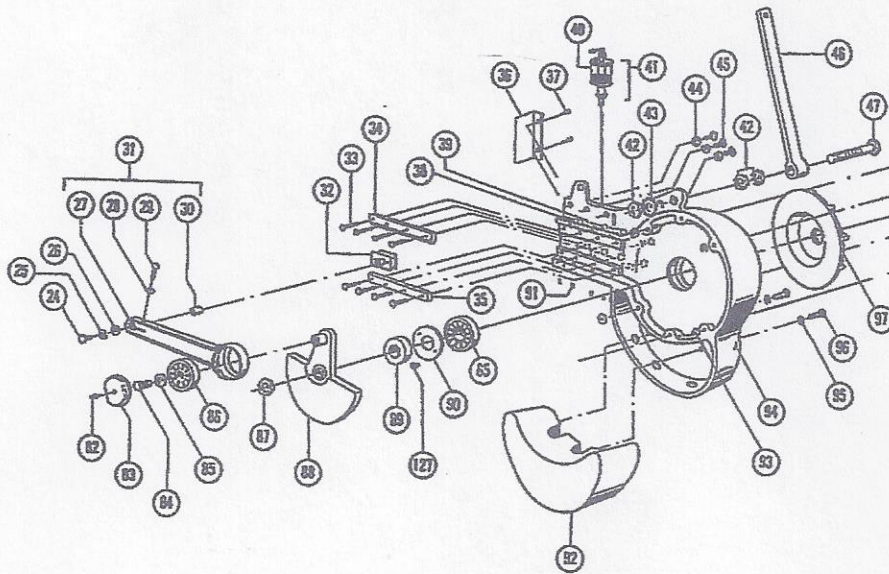

DRIVE COVER SECTION

REF. NO.	PART NO.	DESCRIPTION	QTY.
104	9901545	HEX HEAD SCREWS	3
105	8501600	LATCH SPRING	1
106	8500359	FRONT COVER & PLATE S.A.	1
107	8501460	COVER PLATE S.A.	1
108	9900463	FLAT HEAD SCREW	1
109	6299100	HINGE PIN	1
110	6299200	HINGE SPRING	1
111	9902700	HEX HEAD SCREW	1
112	8500700	GREASE HOLE COVER	1
113	8500300	FRONT COVER	1

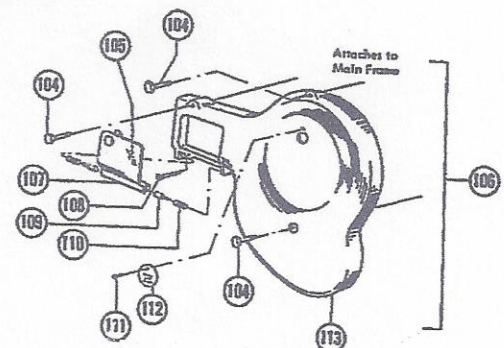

MOTOR & LINE WIRE CONNECTOR PART LISTING

<u>REF. NO.</u>	<u>PART NO.</u>	<u>DESCRIPTION</u>	<u>QTY.</u>
48	8517161	ROTOR - 2 h.p.	1
49	85194xx	STATOR (STATE VOLT., PHASE & CYCLE)	1
50	7541400	GASKET	1
51	8515500	RECEPTACLE HOUSING BASE	1
52	6050001	SCREW	2
53	9901975	LOCK WASHER	4
54	6051500	MALE POST INSERT COUPLING ASSY.	1
55	6051600	MALE POST	5
56	9900965	SCREW	1
57	6051700	MALE GROUND POST	1
58	6051093	SCREW	4
59	6050000	SHELL BASE	1
60	6050500	GASKET	1
61	9901296	SCREW	2
62	9900119	SCREW	2
63	8507000	SPLASH GUARD - REAR HEAD	1
64	8500210	REAR HEAD - VENTED	1
	8530200	REAR HEAD - CLOSED	1
65	8503693	BALL BEARING	2
66	8501000	BEARING COVER	1
67	8511200	ACORN NUT	4
98	85194xx	MOTOR CASE & STATOR (STATE VOLT, PHASE & CYCLE)	1
99	8516110	MOTOR CASE	1
100	9901897	SET SCREW	4
101	8508900	GASKET	1
102	8510600	MOTOR BOLT	4
103	9902668	HEX HEAD SCREW	2
127	6031201	GREASE FITTING	1

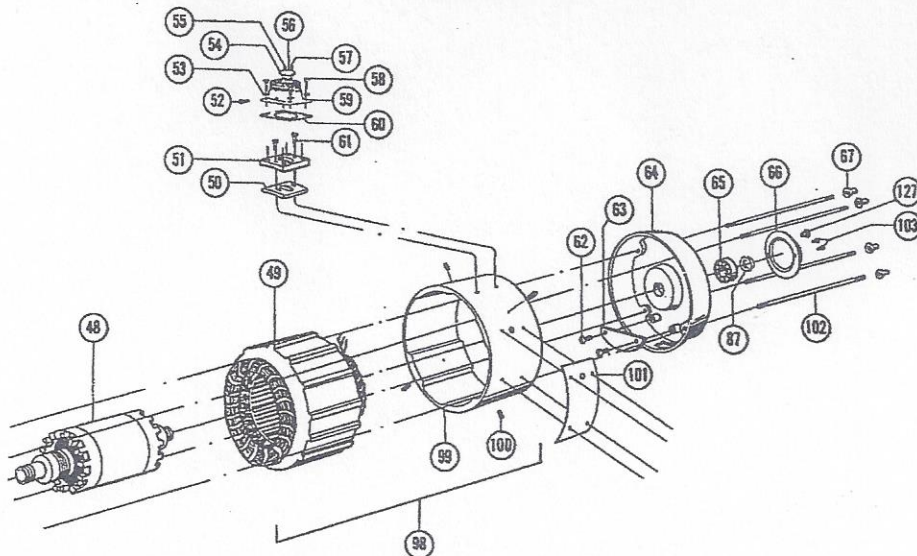

HANDLE & LINE WIRE PARTS LISTING

REAR HANDLE

REF. NO.	PART NO.	DESCRIPTION	QTY.
114	9900406	SCREW	2
115	8508800	SWITCH PLATE	1
116	8510893	SWITCH	1
117	9900096	SCREW	2
118	8509100	SHOULDER SCREW	1
119	8508660	REAR HANDLE & COVER S.A.	1
120	9902762	HEX HEAD SCREW	4
121	8509059	REAR HANDLE COMPLETE	1
122	1235300	SPRING	1
123	9901704	HEX NUT	1
124	9901863	SET SCREW	1
125	8509300	TRIGGER	1
126	9900402	SCREW	1

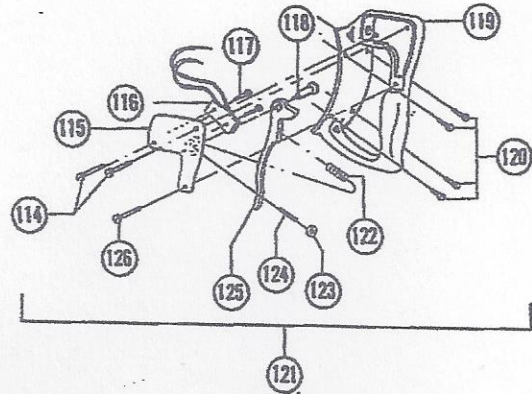

9" DUAL CONTROL SIDE HANDLE

REF. NO.	PART NO.	DESCRIPTION	QTY.
1	9802769	HEX HEAD CAP SCREW	2
2	9753532	COVER PLATE	1
3	9753530	SWITCH HOUSING	1
4	9753549	SWITCH	1
5	9753528	SPACER	1
6	9753509	9" MODULAR HANDLE	1
7	9753541	LEVER	1
8	9753543	PIVOT BRACKET	1
9	9801408	HEX HEAD CAP SCREW	1
10	1208193	RETAINING RING	2
11	6044500	PIN	1
12	9753547	FINGER GUARD	1
13	9800396	SLOTTED FLAT HEAD SCREW	2
14	9753534	O-RING	1
15	6523391	1/4" O.D. HOSE	
16	6288025	WIRE CLIPS	2
17	9802763	HEX HEAD CAP SCREWS	2
18	9801750	STOP NUTS	2
19	6523193	MALE CONNECTOR	1

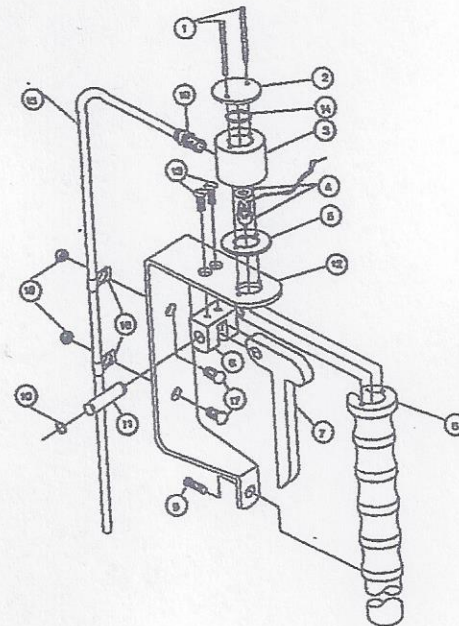

PARTIAL ASSEMBLY KIT AVAILABLE -- INCLUDES ITEMS 1-14
6240060 9" MODULAR HANDLE

220-550 VOLT LINE WIRE SECTION

REF. NO.	PART NO.	DESCRIPTION	QTY.
68	6054100	GASKET	1
69	6053400	PLUG SHELL	1
70	6053593	NUT	1
71	6054093	WIRE CLIP	1
72	6053393	RUBBER GROMMET	1
73	6053293	NUT	1
74	6053193	STRAIN RELIEF	1
75	6053000	COUPLING ASSY.	1
76	1106200	4 WIRE PLUG	1
77	1107600	3 WIRE PLUG	1
78	6052600	LINE WIRE	12 ft.
79	6053700	FEMALE INSERT COUPLING	1
80	6053900	FEMALE GROUND POST	1
81	6053800	FEMALE POST	5
128	6052559	LINE WIRE COMPLETE	1

